



COMPRESORES HERMETICOS

MEDIA TEMPERATURA **R-404A / R22**

Aceite Polyolester

Potencia (Hp)	MODELO	Desplazamiento (cm ³ / rev.)	Carga Aceite cm ³	Enfriamiento	Consumo en Watts	Rendimiento Frigorífico (Kcal/h)					Volts / Nº f / Hz	RLA (A)	LRA (A)	Ø Succión	Ø Descarga	Peso Bruto Kg	Altura (mm)	Cap. Arranque µf 330VAC	Cap. Marcha µf 440VAC
						Temperatura Evaporación													
						-15°C	-10°C	0°C	+7,2°C	+15°C									
1/3	GDCO033MC	8,9	417	V	720	420	556	810	980		220/1/50	2,7	13	5/16"	1/4"	11,5	205	50	8
1/2	GDCO050MC	12,0	417	V	740	560	690	995	1295		220/1/50	3	13	3/8"	1/4"	12,5	215	43	15
3/4	GDCO0075MC	18,0	467	V	970	860	1050	1540	1890		220/1/50	5	16	3/8"	1/4"	12,5	215	50	20
1	GDCO0100MC	21,5	850	V	1122	1050	1300	2020	2650		220/1/50	5,4	30	1/2"	3/8"	21,5	264	100	25
1 1/2	GDCO0150MC	34,5	850	V	1210	1830	2350	3500	4500		220/1/50	9,7	50	1/2"	3/8"	25,74	264	130	30

Temperatura Condensación: 54°C

V = Ventilación Forzada

Compresores 1/3; 1/2; 3/4 Hp

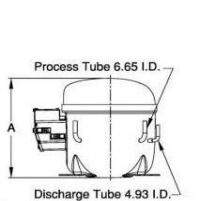

Compresores 1; 1 1/2 Hp

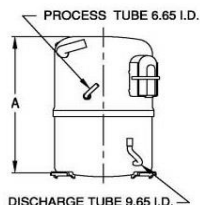

DIMENSIONES GENERALES

Hp	Modelo	A	B	C	D	E
1/3	GDCO033MC	205	233	160	165	102
1/2	GDCO050MC	215	233	160	165	102
3/4	GDCO0075MC	215	233	160	165	102
1	GDCO0100MC	264	223	203	122	239
1 1/2	GDCO0150MC	264	223	203	122	239

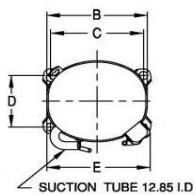
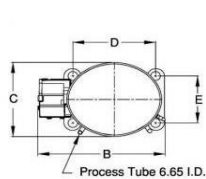

Conexion Electrica 1/3; 1/2; 3/4 Hp

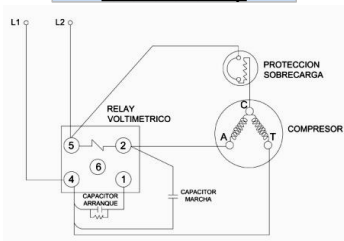

Conexion Electrica 1Hp

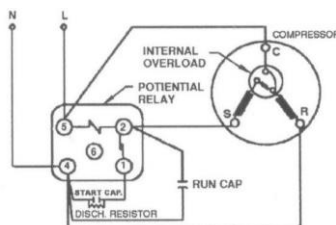

Conexion Electrica 1 1/2Hp

